

2025 Start of Year Info



21st January, 2025

A special welcome to all the new families joining The Gardens School in 2025.

In order to ensure a smooth start back to school for everyone, please make sure you have familiarised yourself with all the information in this newsletter, as there are specific details for different year levels.

First Day Procedures: Tuesday 28th January

ALL Year 1 and 2 (*Kiwi and Kākāpō*) students are to **enter school at their usual gate at Arua Park, from 8.15am**, they will be going straight into class with their teachers and **will not be meeting in the hall.**

ALL Year 3 - 8 (*Pūkeko, Kōtuku, Tūi and Kāhu*) students are to **make their way to the school hall from 8.15am**. Entry will be via the doors closest to the basketball court. Staff will point you in the right direction if you are unsure where to go.

Hapori Leaders and teachers will be in the hall and at the Arua Park gate to welcome students and help them know where to go. Drop off at the hall is strongly encouraged for Year 3-8 students. There will be many staff on hand to help with anxious students and first day nerves, and we highly recommend the coffee at Cafe Aroha for any parents who might have first day nerves themselves :)

At 8.50am we will begin moving Y3-8 students to their learning spaces and our school day will begin.

What to Bring

Please make sure your child is prepared for the start of the new school year, in their correct school uniform and with their stationery pack, ready for the day. They will need their **school hat**, morning tea and lunch packed in their own named lunchbox and a named water bottle. It is expected that every child has their own school bag to keep their belongings in.

Pick Up - End of Day

School ends at 2.50pm. Years 3-8 students are dismissed into Central Park and parents/caregivers are welcome to wait in this area to collect them. Central Park can be accessed via the top field, from the pedestrian path beside the shops or via the bottom gate at Arua Park (closest to the caretakers shed).

Kiwi and Kākāpō (Year 1 and 2) - We continue to offer an OPTIONAL early pick up for students in Kiwi (Year 1) and Kākāpō (Year 2). Children in these teams can be collected **any time between 2.30pm and 2.50pm**. Pick up of all Kiwi and Kākāpō children is from the Arua Park gate closest to the office. **Please wait outside the gate** and your child will be brought out to you. **Please note there is no parent access into Arua Park at this gate.**

We have provided a map on the next page to indicate the pick up points. The green lines indicate how to access Central Park if you are picking up students in Year 3-8.

Pick Up Points

★ Kiwi and Kākāpō (Year 1 and Year 2)
At the Arua Park Gate

Pūkeko (Year 3)
Kōtuku (Year 4)
Tūī (Year 5/6)
Kāhu (Year 7/8)

In Central Park
(access marked by green arrows)

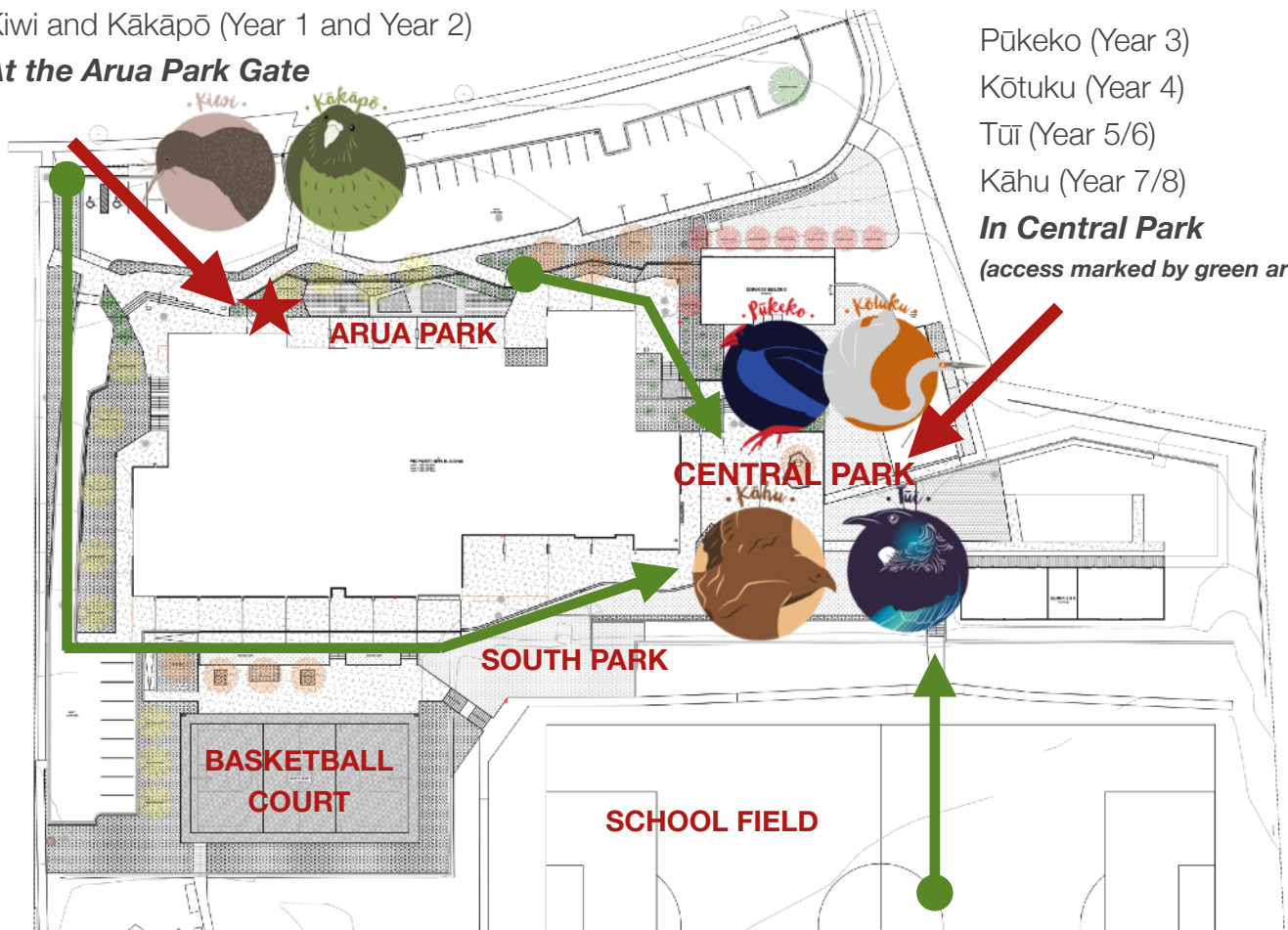

Drop off from Day 2 onwards

From Wednesday 29th January, **all students are to be dropped off** at their allocated entry point **from 8.20am.**

Kiwi and Kākāpō at the Arua Park Gate. Staff will be at the gate to welcome them in.

All students from Year 3-8 enter school at the Library Doors in Central Park. Staff will be at doors to welcome them in.

Important Reminders

SAVE THE DATE: Wednesday 12th February

5.00pm - Junior Curriculum Information Meeting; 5.30pm - Open Night - Meet the Teachers

Friday Drop In

Parents are invited into teaching spaces **every Friday morning from 8.20am - 8.50am.** This is a great opportunity for your child to show you around their space and share what they have been up to.

Teachers are still available every day at the Arua Gates and Library doors if you have any questions you need to ask.

Before and After School Care

This will continue to operate out of the Weka block. All inquires should be made to Carolyn Payne email: carolyn@kidsafterschool.co.nz or Phone: 0274435207. Please note this is run by an external provider, not the school.

Important Reminders cont.

School lunches

Options for purchasing school lunches will not begin until the term is underway and we will let you know when this is up and running. All students need to have morning tea and lunch in a named lunchbox, every day.

Stationery Orders: 2025

You will have already received the information for how to order your child's stationery. If you have not yet done so, please go to this link <https://www.myschool.co.nz/> and enter The Gardens School, to see the requirements list for each Hapori.

Please ensure you order the full list of items for each child. We endeavour to keep stationery requirements to the minimum, and **everything that is listed is required.** We choose to use Office Max for quality and consistency, particularly with exercise books, as these can vary greatly between brands, so please do not substitute items.

BYOiPAD: Year 5, 6, 7 & 8

Students from Year 5 - 8 are required to bring an Apple iPad to school. Information about our BYOiPad programme was sent to all Year 4 families in 2024. The Gardens School runs on an Apple Platform, so Apple iPads (or MacBooks) are the only devices supported at school.

If you have any questions regarding our BYOiPad programme, please contact our Lead Teacher of IT, Christine Hansen, christineh@thegardens.school.nz

School Uniforms

All students must start the new school year, in full correct summer uniform. Sandals are recommend for the summer terms and must be **plain black, including the sole.** They must stay on well, with a strap around the back of the ankle. School shoes should be appropriate for school (not a fashion shoe), must stay on well and must be **plain black, including the sole** and worn with **plain black or white ankle socks.**

School hats are compulsory in Term 1. **Year 0-6 students must have the tan bucket hat.**

Any new or replacement items must be purchased in time for the start of the year, via [Argyle Online.](#)

For full details about our uniform expectations, please see our website: <http://www.thegardens.school.nz/information/school-uniform/>

Uniform requirements for Year 7/8:

Students in Kāhu (Year 7/8) have a slightly different uniform to the rest of the school. This is designed to identify them as our school leaders.





All Kāhu Year 7/8 students require:

- The BLACK school cap or BLACK school bucket hat
- Dark grey intermediate skirt or dark grey intermediate shorts
- All other uniform items remain the same, including plain black shoes or sandals and plain black or white socks.

2025 SCHOOL ORGANISATION

We are pleased to be fully staffed for the start of the 2025 school year and we extend a warm welcome to our new teachers, Toria Clifford, Melissa Berry, Morgan Siau and Bonnie Crane.



HAPORI	HAPORI LEADER	TEACHING TEAM
Year 0/1 	Hayley Williams	Hayley Williams Fetuna-Rowena Seumanu Reem Mesmar Maninder Kaur Megan Brake Brenda McDonald
Year 2 	Paige Starrkley	Paige Starrkley Yajun Wang Toria Clifford Jill Haywood
Year 3 	Amy Luck	Amy Luck Preet Panglia Antonina Lemalu
Year 4 	Genna Pienaar	Genna Pienaar Sara Hayward Melissa Berry Anna Howe Sharon Scown
Year 5/6 	Lua Mauga	Lua Mauga Jen Goodwin Elizabeth Barrowman Morgan Siau Zia Burdukany
Year 7/8 	Dharia Bearda	Dharia Bearda Chané van Tonder Bonnie Crane Ting Wang Charlotte Green Fawna Dissmeyer
Matanga Hapori: Specialist Teachers	Lisa Cosford	Lisa Cosford - Wellbeing Grace Saleupolu - Music Kate Watson - PE and Sport Viv Lee - Spanish and Textiles Technology Juanita Swanepoel - Food Technology Karen Davies - Enviro Chris van Tonder - Science
Ako Hapori: Learning Support	Sepa Tala'imanu	Sepa Tala'imanu - SENCO Carol Kent - SENCO
Senior Leadership Team	Principal Deputy Principal Associate Principal Head of IT (<i>Device Principal</i>)	Susannah Fowler Kate Gifford Sepa Tala'imanu Christine Hansen

2025 Hapori Teaching Spaces

ARUA - LEVEL 1

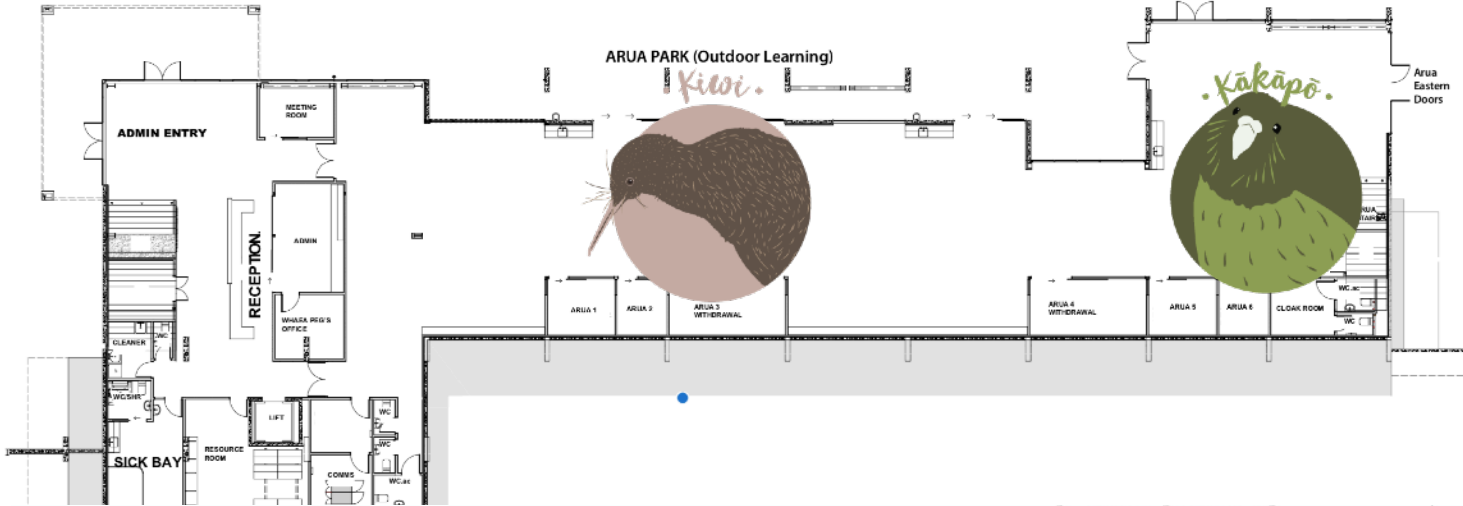

TIWAI - LEVEL 2

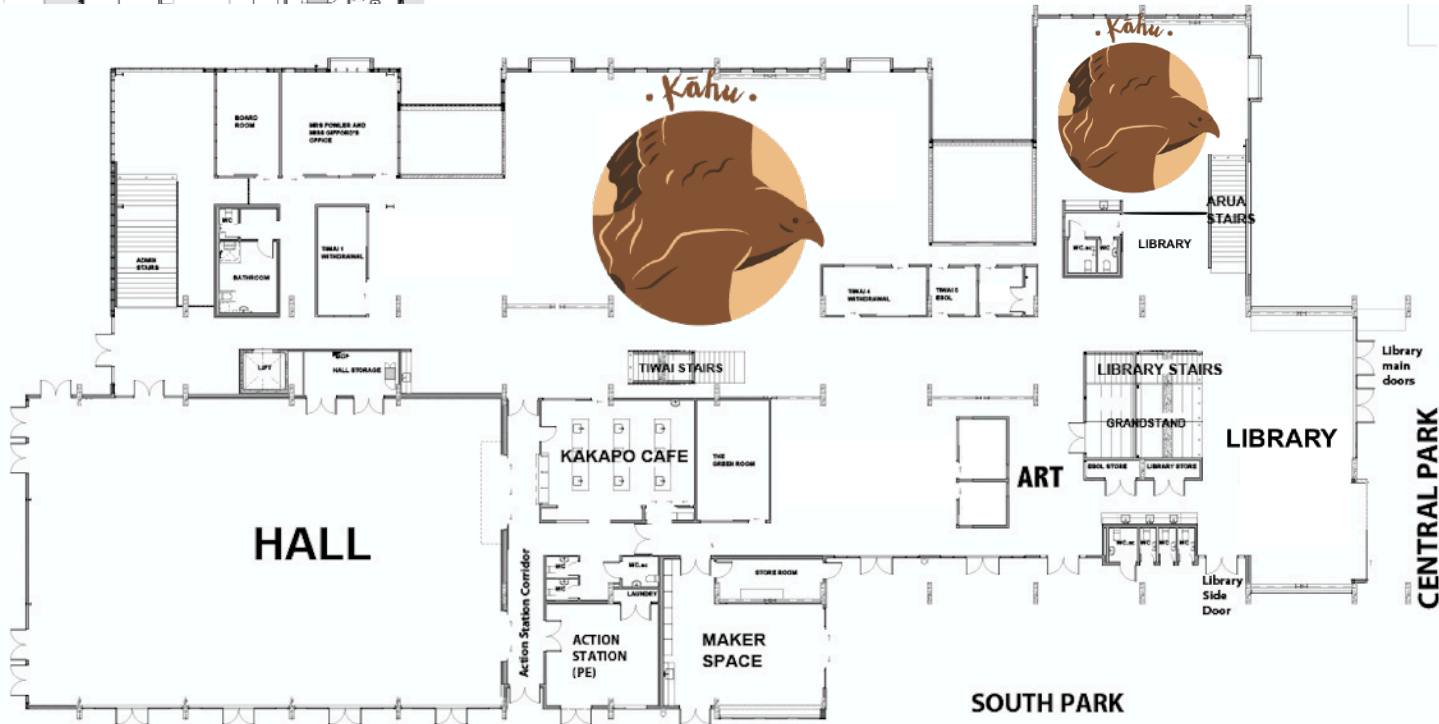

OHUNGA - LEVEL 3

